



Phone: 1-800-648-4301  
(631) 728-3986



**ENHP**  
(Enhanced Pulsor)



**HPP**  
(High Performance Pulsor)



**DSE**  
(Deck Sensor)

## Choosing the right Pulsor?

- \* Identified by two brown wires
- \* Solid Joists (2x8, 2x10, center of span 2x12)
- \* TGI [I truss] (2x8, 2x10, center of span 2x12)
- \* Staircase for security or automation
- \* Parallel cord wood trusses
- \* Open web steel trusses
- \* Boat Gunwales

- 
- \* Identified by two white wires
  - \* Solid Joists or TGI Joists larger than 2x12
  - \* All Microlam Joists
  - \* Staircase for automation
  - \* Mega-yachts with aluminum construction

- 
- \* Identified by one white and one orange wire
  - \* Joists 2x6 and under
  - \* Fire Escapes
  - \* 2x6 or 2x8 "C" or "Z" joists on Butler Buildings
  - \* Fiberglass boat decks

## SOLID JOISTS



## TGI JOISTS

### T.G.I (SILENT FLOOR)

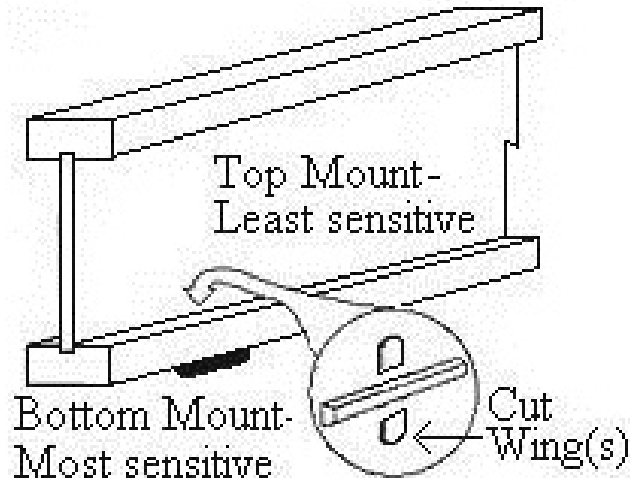

## STAIRCASES

Sensors installed on staircases should always be on their own processor zone.

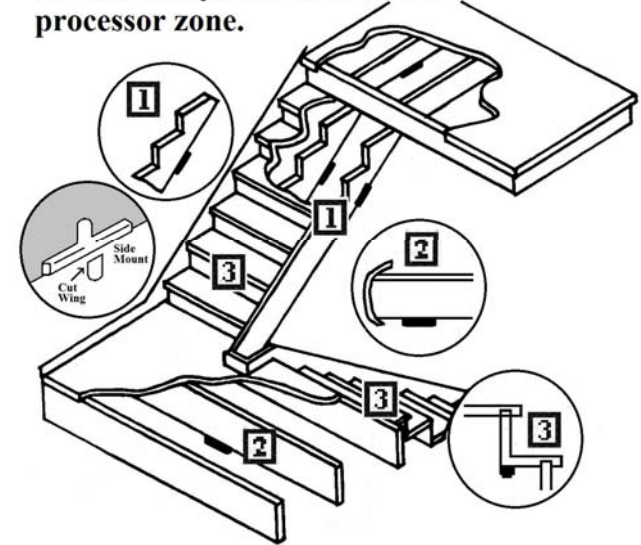

## PARALLEL CORD TRUSS

### PARALLEL CORD WOOD TRUSS

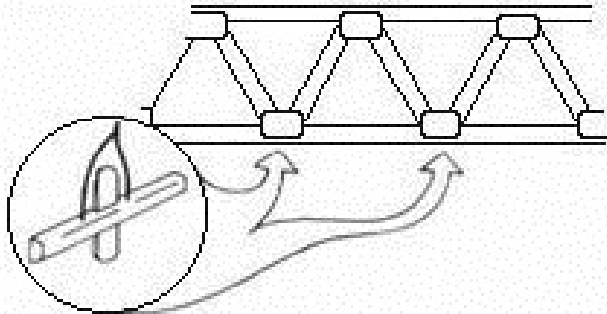

Install at bottom of 'Web'



## OPEN WEB TRUSS

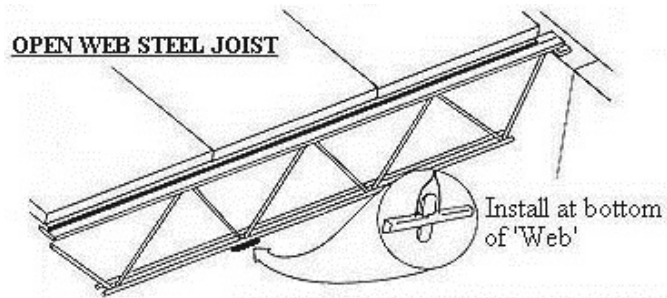

## BOAT GUNWALES





## MICROLAM JOISTS



## MEGAYACHTS



## ALUMINUM CONSTRUCTION



# STEEL FIRE ESCAPES

## Steel Fire Escape

Clean surface to remove dirt and oils.

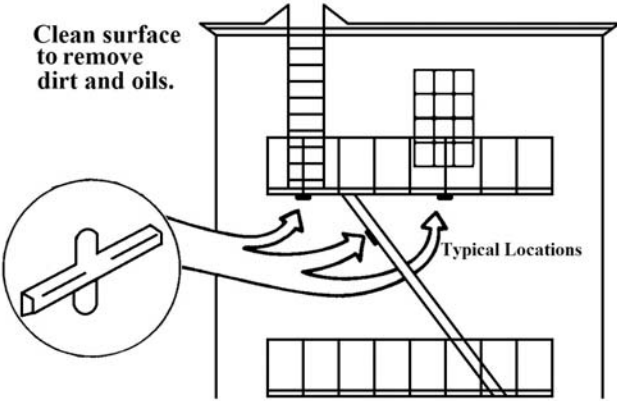

# BUTLER BUILDINGS

## STEEL ROOF (BUTLER TYPE BUILDING)

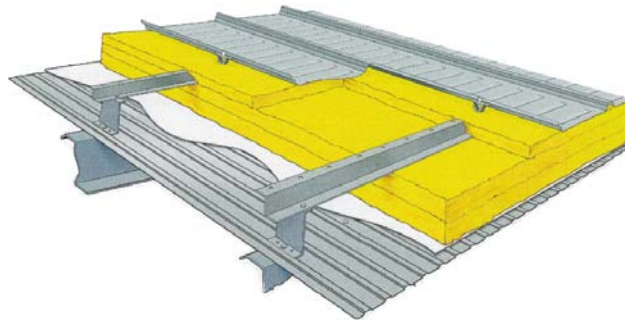
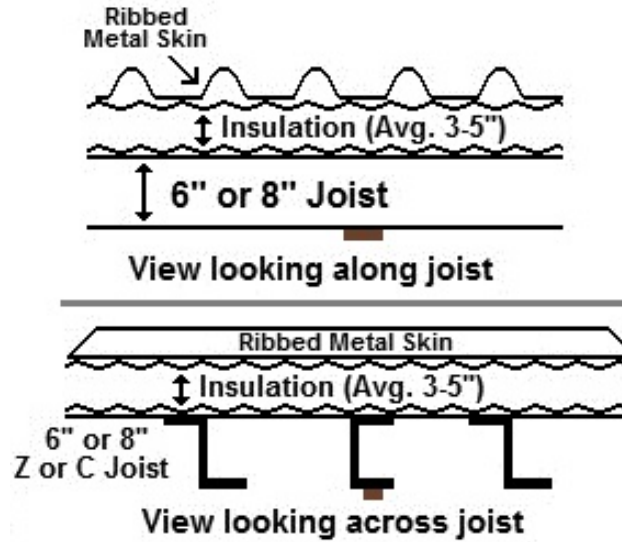

# BOAT DECK (Fiberglass)

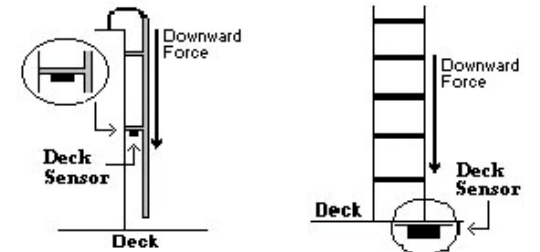
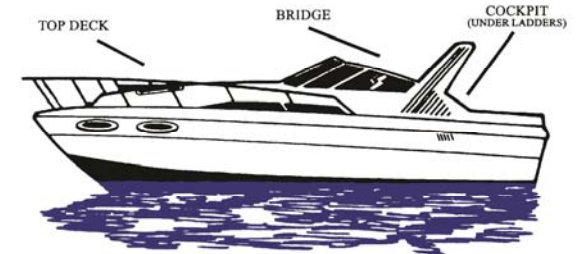

On angle iron supporting ladder

Under decking below ladder

